

AEE EV Fuse



FEATURES:

- 690 VAC automotive grade EV fuse
- Rated Current: 200-630 A
- Rated Breaking Capacity: 50 kA
- Dimensions: 64x51x52 mm, flush end contact mounting
- Fast Acting fuse for EV/HEV, HV Connectors, Manual Service Disconnects (MSD)
- Ref. to IEC 60269-4

ELECTRICAL SPECIFICATIONS

Part Number	Rated Current	Ampere Code	Rated Voltage	Breaking Capacity	0.5I _n Dissipation (W)
AEE3200d00	200A	3200	690 VAC	50 kA@690 VAC	5.4
AEE3250d00	250A	3250			7.0
AEE3315d00	315A	3315			8.6
AEE3350d00	350A	3350			9.7
AEE3400d00	400A	3400			10.5
AEE3450d00	450A	3450			11.0
AEE3500d00	500A	3500			12.0
AEE3630d00	630A	3630			14.5

Note:

(1) Temperature Rise: ≤60 K at 50 % of rated current

PART NUMBER SYSTEM



1Product Series AEE
 2 Ampere Code 350 A (see ampere code column of electrical specifications)
 3 Rated Voltage..... d: 690V
 4 Supplementary Code 00: default (special size see to detail image)



adler®
DIMENSIONS (mm)

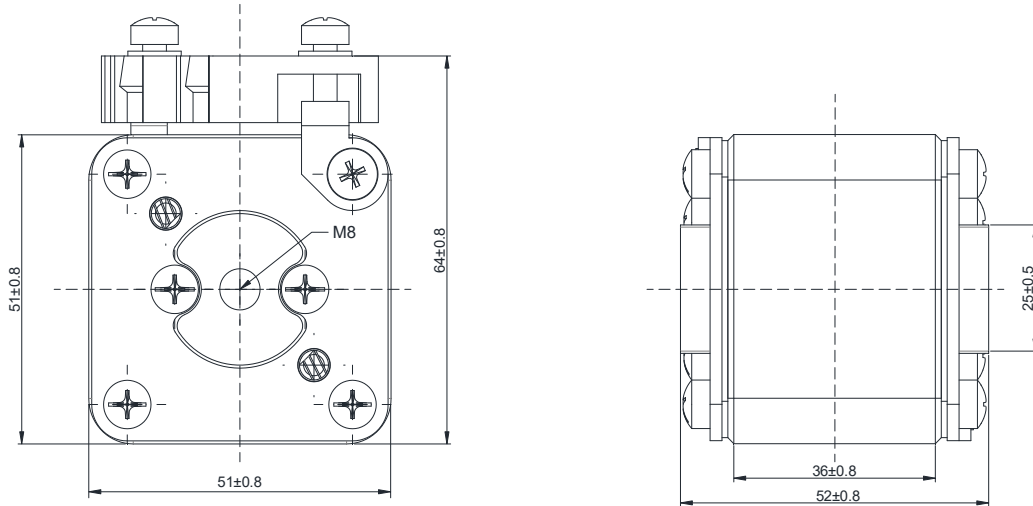

TIME CURRENT CURVE

